

**REPARO DA COLUNA DE CONCRETO      FOLHA 3**

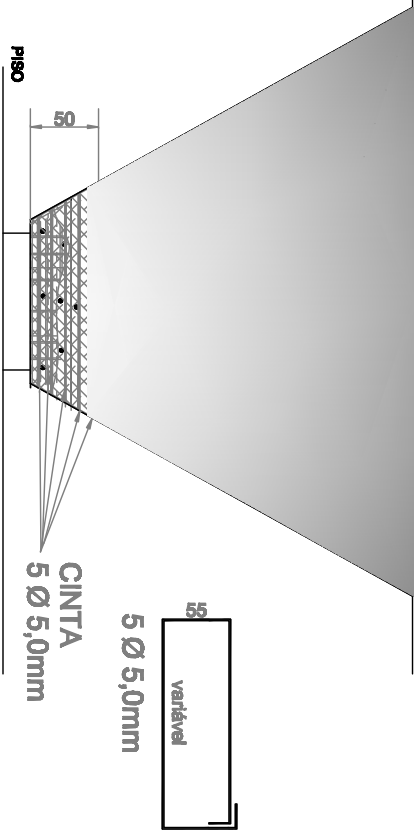

**CINTAMENTO DO PILAR**

**7** COLOCAR FERROS DE 5,0mm NO SENTIDO HORIZONTAL, ESPAÇADO DE 10 A 15 cm, ENVOLVENDO TODO PILAR.

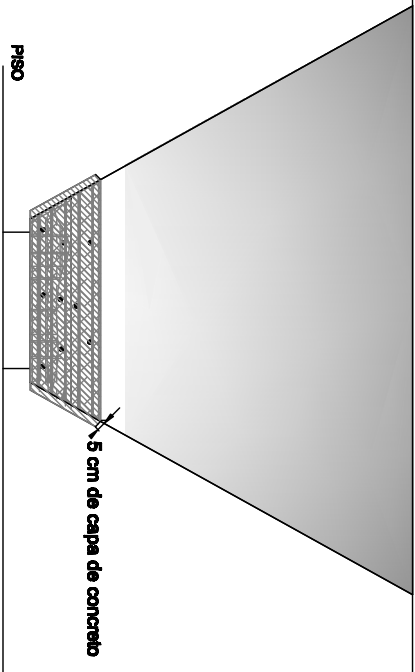
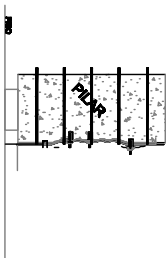

**8.** CONCRETAR, COM ESPESSURA DE 5 cm, ALTURA 50cm, TODO PERIMETRO DO PILAR.

CONCRETO COM PEDRISCO.

4 LATAS DE PEDRISCO  
5 LATAS DE AREIA GROSSA  
1 SACO DE CIMENTO